

GOLDAIR

Hands Free Can Opener

Model FC0200

OPERATING INSTRUCTIONS



FC0200 – Battery Operated (2 x AA), Hands Free Can Opener

Thank you for choosing a GOLDAIR Hands Free Can Opener. This GOLDAIR appliance has been designed and manufactured to a high standard of engineering and with proper use and care, as described in this leaflet, will give you years of useful service. Please read these instructions carefully.

GENERAL CARE AND SAFETY GUIDE

PLEASE READ ALL INSTRUCTIONS CAREFULLY AND KEEP THEM FOR FUTURE REFERENCE.

ALWAYS

- ✓ Always operate the Can Opener on a level surface.
- ✓ Always ensure the motor has stopped completely before taking off the bottom cover for battery replacement.
- ✓ Take care when replacing batteries that the switch on the bottom or the buttons on the top of the Can Opener are not pressed accidentally as the unit will turn on and may cause injury.
- ✓ Always remove batteries before cleaning the can opener or cutting blade to avoid accidentally turning the unit on.
- ✓ Keep fingers away from the cutter at all times.
- ✓ Avoid contact with moving parts, Keep hands, hair, jewellery, clothing etc. away from moving parts during operation to prevent injury and/or damage to the Can Opener.

NEVER

- ✗ NEVER USE THE CAN OPENER TO OPEN PRESSURIZED (AEROSOL TYPE) CANS.
- ✗ DO NOT OPEN CANS OF FLAMMABLE LIQUIDS SUCH AS LIGHTER FLUIDS.
- ✗ Never use this appliance for any purpose other than its intended use. This appliance is for household use only.
- ✗ This appliance is not intended for use by persons (including children) with reduced physical, sensory or mental capabilities or lack of experience and knowledge, unless they are supervised or have been given instruction concerning the use of the Can Opener by a person responsible for their safety.
- ✗ Close supervision is necessary when the appliance is near children.
- ✗ DO NOT immerse the Can Opener in water or any other liquid. (Please see the CARE AND MAINTENANCE section for cleaning instructions.

CAN OPENER PARTS & FUNCTIONS

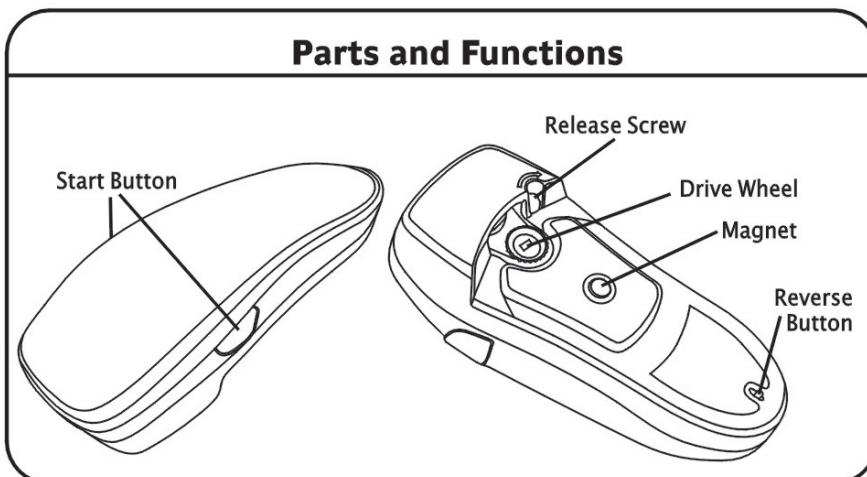

TECHNICAL DETAILS

Operated voltage: DC2.4-3V

Batteries: 2 x AA Alkaline or AA rechargeable batteries.

Maximum can cutting size in one cycle: Diameter of 90mm (3.5")

WARNING: NEVER USE THE CAN OPENER TO OPEN PRESSURIZED (AEROSOL TYPE) CANS OR CANS OF FLAMMABLE LIQUIDS SUCH AS LIGHTER FLUIDS.

BATTERY INSTALLATION

To install (and remove) 2 AA Alkaline batteries into the battery compartment, slide back the bottom cover by holding the unit with the bottom facing up and the narrow end toward you.

Place each thumb on each side of the magnet and pull toward you. The battery cover will snap off for easy removal. Replace the bottom cover after the batteries have been installed (**See fig. 1**) Always replace both batteries at once and never mix old and new batteries or batteries of different types.

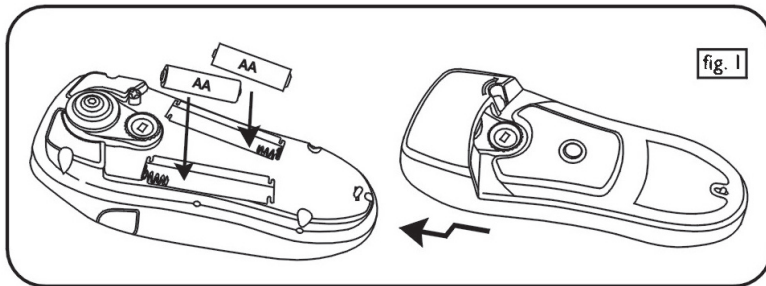

OPERATING THE CAN OPENER

1. Place the Can Opener on top of the can with the rim of the can positioned in the groove of the cutter at the bottom of the Can Opener (*see Fig. 3*)
3. With the can on a flat surface, press and hold the Start buttons for approximately 1 second. Release the buttons when the Can Opener starts to operate. (*See Fig 4*). The Can Opener will stop automatically.

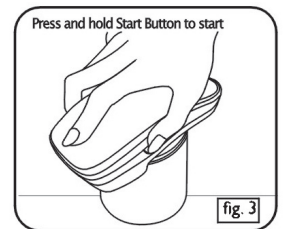

DO NOT ATTEMPT TO STOP OR REMOVE THE CAN OPENER UNTIL THE 20 SECOND CYCLE IS COMPLETE AND THE MOTOR HAS STOPPED.

Note: For cans smaller than 3.5" in diameter, DO NOT attempt to stop or remove the Can Opener until the 20-second cycle is complete and the motor has stopped. For cans larger than 3.5" in diameter, once the initial 20-second cycle is complete and the motor has stopped, firmly press the start buttons and release when the Can Opener begins a second cycle.

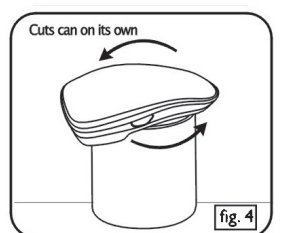

4. Once the cutting cycle is complete, lift the Can Opener off the can. For your convenience, a magnet in the centre of the Can Opener will pick up the lid as well. (*See Fig. 5*)

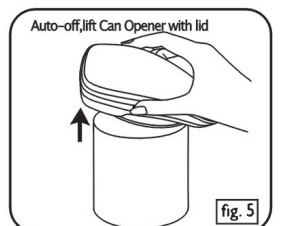

Note: The cut edge of the can lid will be sharp and should be handled with care.

CARE & MAINTENANCE

1. If the Can Opener slows during cutting, this may indicate a low battery level and the batteries should be replaced. If the Can Opener stops during operation, see the Trouble Shooting section below.
2. Prior to cleaning the Can Opener, first slide off the bottom cover and remove the batteries as a safety precaution. Wipe the cutter with a damp cloth or a sponge, using a mild non-abrasive cleaner followed with a clean dry cloth to dry it completely.

TROUBLESHOOTING

1. If the Can Opener is jammed, push and hold the small black reverse button at the bottom rear of the Can Opener. Continue to hold the button down and the Can Opener will reverse direction and return to the starting position once the motor has stopped. *(See Fig. 6 below).*
2. If the batteries are drained and the Can Opener cannot be released by pressing the reverse button, insert a screwdriver into the release screw. Gently turn it in a clockwise direction until the can is released. *(See Fig 7 below).*
3. Cans with thick seams, odd shapes or uneven rims may stall the Can Opener. If this happens, follow procedure #1 above. Start the cutting action just beyond any minor bump or dent in the can.

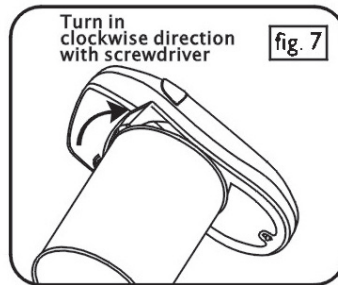
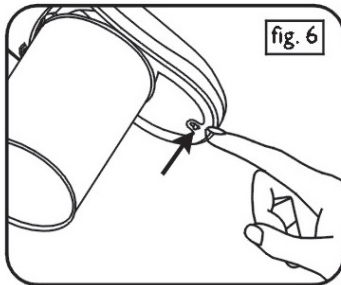

Note: The Can Opener will not open rimless cans or cans with odd corners.

GOLDAIR

SUPPORT AND TECHNICAL ADVICE

North Shore City, Auckland, New Zealand

Monday – Friday 8am-5pm

Phone: 0800 232 633

Website: www.goldair.co.nz

GOLDAIR

Your Goldair product has been inspected and tested and is guaranteed subject to the following for a period to two years from the date of purchase against defects in workmanship and materials. During this period, such defects will be rectified by repair or replacement of the product purchased. Your product contains no user serviceable components and this warranty becomes invalid if in our opinion the product has been misused, abused, incorrectly installed, tampered with, connected to an electrical supply not corresponding with the name plate specification, or subjected to power surges. The warranty does not include any labour or other associated expense that may be involved in removal or installation of the product. Normal wear and tear is expressly excluded.

If your Goldair product fails to operate satisfactorily, please return it to the retailer from whom it was purchased. To obtain a repair or replacement product under this warranty, you will need to produce satisfactory evidence of date of purchase. The completed warranty and purchase receipt must be presented with the product. The warranty should be filled out at the time of purchase. It is in your interest to make sure this is done.

If the product is to be replaced (cannot be repaired) then that replacement will be of the same or similar product or accessory excluding packaging, instruction card etc. Where a replacement product is supplied, this shall be guaranteed for the balance of the original warranty period.

Any model that is no longer available will be replaced by a model of a value and with such features as we consider appropriate in the circumstances. Goldair Ltd is not responsible for freight forwarding charges, losses or damage in transit.

If service is required after the warranty period has expired, the product should be returned to a qualified electrical technician. Service outside of the warranty period will be at your cost.

Consumers Guarantee Act (1993).

In accordance with the above act consumers are advised that: The manufacturer does not undertake that repair facilities and parts are necessarily available for this product.

If any of the provisions of the foregoing are contrary to any relevant legislation, then that provision shall be deemed to be excluded from the warranty and the rest of the provisions will continue to apply.

IMPORTANT: PLEASE RETAIN THIS WARRANTY CARD

NAME: _____

ADDRESS: _____

PURCHASED FROM: _____

SUBURB: _____

DATE OF PURCHASE: _____

NAME OF PRODUCT: _____

MODEL No: _____

TWO YEAR WARRANTY