

# GOLDAIR

Slow Cooker

Model GSL150

OPERATING INSTRUCTIONS



GSL150: 230 - 240V~, 50Hz, 200W, 3.5 Litre Slow Cooker

Thank you for choosing a Goldair electric Slow Cooker. This Goldair appliance has been designed and manufactured to high standards of engineering and with proper use and care, as described in this leaflet, will give you years of useful service. Please read these instructions carefully.

## GENERAL CARE AND SAFETY GUIDE

### ALWAYS

- ✓ Always ensure hands are dry before handling the plug or the Slow Cooker.
- ✓ Always operate the Slow Cooker on a secure, dry, level surface.
- ✓ Always allow adequate air space above and on all sides for air circulation. Do not allow the Slow Cooker to touch curtains, wall coverings, clothing, dishtowels or other flammable materials during use. Do not use under cupboards or curtains.
- ✓ Caution is required on surfaces where heat may cause a problem – an insulated heat pad is recommended.
- ✓ Always be sure to unplug from the socket when not in use and before cleaning.
- ✓ Always allow the Slow Cooker to cool before cleaning and storing.
- ✓ Carry out regular checks of the supply cord to ensure no damage is evident.
- ✓ Return the Slow Cooker after a malfunction, or if it has been damaged in any manner to an authorised electrician for examination, repair or adjustment as special purpose tools are required.
- ✓ Take care not to scratch the special coating of the cooking plate. Use a wooden or heat resistant plastic spatula.

### **CAUTION:**

THE SLOW COOKER GENERATES HEAT AND STEAM DURING USE. PROPER PRECAUTIONS MUST BE TAKEN TO PREVENT THE RISK OF BURNS, SCALDS, FIRES OR OTHER DAMAGE TO PERSONS.

### NEVER

- ✗ Never touch hot surfaces.
- ✗ Never use this appliance outdoors.
- ✗ Never use this appliance for any purpose other than its intended use. This appliance is for household use only.
- ✗ This appliance is not intended for use by persons (including children) with reduced physical, sensory or mental capabilities or lack of experience and knowledge, unless they are supervised or have been given instruction concerning the use of the Slow Cooker by a person responsible for their safety.
- ✗ Close supervision is necessary when the appliance is near children.
- ✗ Never leave the appliance unattended when in use.
- ✗ Never place this appliance on or near a hot gas or electric burner or where it could touch a heated oven or microwave oven.
- ✗ Exercise caution if using foodstuffs containing sugar or products containing jam or preserves, as the fillings may become very hot.
- ✗ Never immerse any part of the Slow Cooker, or cord set and plug in water or any other liquid to protect against electrical hazards.
- ✗ Never use harsh, abrasive or caustic cleaners to clean this appliance.
- ✗ Never operate the appliance with a damaged cord or plug, after it malfunctions, or if it has been damaged in any manner.
- ✗ The Slow Cooker is not intended to be operated by means of an external timer or separate remote-control system.

# COMPONENTS

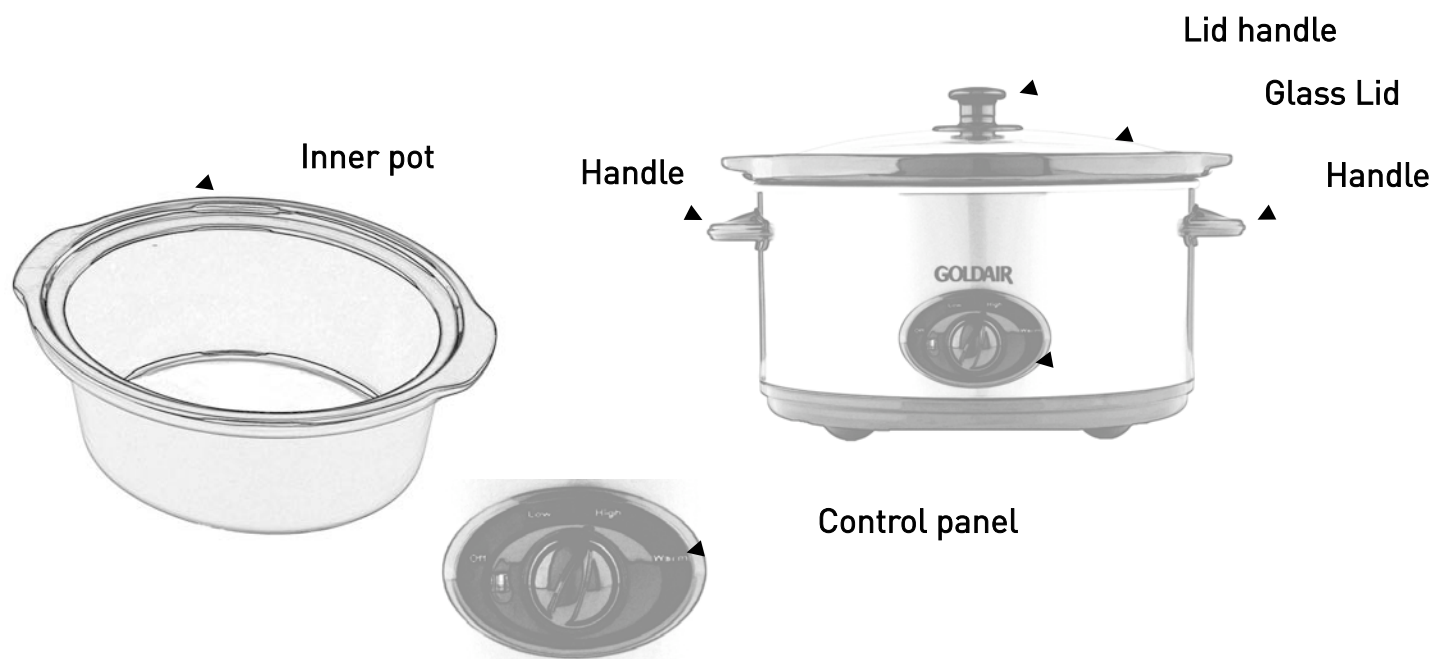

## FEATURES

**Removable Ceramic Crock** to make serving meals and cleaning easy.

**Tempered Safety Glass Lid** for easy viewing without losing heat and to retain heat and moisture during cooking.

**3 Heat Settings** with LOW, HIGH and KEEP WARM options.

**Large Capacity Oval Ceramic Bowl** for large cuts of meat and family sized meals.

**Cool Touch Handles and Knob** to allow for easy manoeuvring to the table for serving.

## SAFETY DURING USE

Use oven gloves when handling the pot or removing the lid after or during use.

Keep out of reach from children.

Allow the lid to cool before immersing in water.

Do not immerse the slow cooker housing in water or any other liquid.

Do not leave the base unit switched ON without the ceramic bowl in place.

The metal inner lining of the slow cooker will remain hot when it is turned ON, and immediately after cooking. **DO NOT TOUCH.**

Ensure that the plug and electrical connections remain dry at all times.

**NOTE:** Do not fill the ceramic crock to the rim as the liquid will overflow during cooking.

Do not place the ceramic crock directly on a heat source or in the oven.

It is normal for the outside of the slow cooker to heat up during long periods of cooking.

## A GUIDE TO SLOW COOKING

- ★ Slow cooking occurs at temperatures below boiling point, liquids do not boil quickly at this temperature. There is little steam or evaporation, food will not stick and virtually no stirring is required. Slow cooking helps retain both flavours and nutrients.
- ★ The slow cooker can operate on LOW all day and night if required.
- ★ When on the HIGH heat setting it will cook similarly to a covered pot on a stove, foods will cook in approximately half the time of that set on LOW.
- ★ When cooking on the HIGH heat setting, additional liquid may be required.
- ★ Vegetables such as carrots, potatoes and turnips require longer cooking than many meats. Place them on the bottom of the ceramic bowl and cover with liquid.
- ★ If adding fresh milk or yoghurt, this should be done during the last 2 hours of cooking.
- ★ Evaporated milk may be added at the start of cooking.
- ★ Rice, noodles and pasta are not recommended for long cooking periods. Cook them separately and then add to the cooker during the last 30 minutes.
- ★ During cooking, ensure liquid ingredients are warmed before adding.
- ★ If cooking frozen food, add some warm liquid before putting in the ceramic crock. If the bowl is hot do not add cold food.

## USING THE CONTROL PANEL

- ★ The Slow Cooker is equipped with 3 heat settings.
- ★ Once your slow cooker is plugged into the power supply, switch the control dial to either the LOW or HIGH temperature setting. The red display light will activate to show your slow cooker is turned on.
- ★ When the cooking cycle is complete, you can keep the food at serving temperature by switching the dial to the WARM position.
- ★ Switch the control dial to the OFF position before removing the plug from the mains power supply.

FOOD	REQUIRED TIME	DEFAULT HEAT
Roasts	8:00 hours	LOW
Stews/Soups	6:00 hours	HIGH
Fish/Poultry	5:00 hours	HIGH
Dips/Desserts	2:00 hours	HIGH

## USING YOUR SLOW COOKER

- ★ For hygiene reasons we recommend that you wash the removable ceramic crock in hot soapy water, rinse and dry before use.
- ★ **NOTE:** When you first use your slow cooker, you may notice a slight odour due to the burning off of manufacturing residues. This will disappear after the first use.
- ★ Ensure that you place your Slow Cooker on a clear, flat work surface near a suitable Mains Power Socket.
- ★ Plug the cord into the Mains Power Socket.
- ★ Add the ingredients of your choice.
- ★ Attach the lid. The lid should not be removed during use. Frequent lifting of the lid during use can delay the cooking time.
- ★ Set the temperature to either LOW or HIGH.
- ★ **CAUTION:** The KEEP WARM setting should only be used after completely cooking the recipe according to the instructions. The food must be hot enough to prevent bacterial growth before using the KEEP WARM setting. Do not use the KEEP WARM setting to reheat any food, especially if it has been refrigerated or frozen.

## CARE AND CLEANING

- ★ Before cleaning your slow cooker always allow the unit to thoroughly cool down.
- ★ Clean the ceramic bowl in hot soapy water, rinse and dry thoroughly.
- ★ Before cleaning the metal inner lining of the base unit, disconnect from the Mains Power Supply.
- ★ Clean the base unit with a cloth dampened by water only. Do not immerse the appliance or its cord in water or any other liquid. Do not use polish or detergents as these may damage the finish of the outer casing.

# GOLDAIR

### SUPPORT AND TECHNICAL ADVICE

North Shore City, Auckland, New Zealand  
Monday – Friday 8am-5pm  
Phone: 0800 232 633  
Website: [www.goldair.co.nz](http://www.goldair.co.nz)

# GOLDAIR

Your Goldair product has been inspected and tested and is guaranteed subject to the following for a period to two years from the date of purchase against defects in workmanship and materials. During this period, such defects will be rectified by repair or replacement of the product purchased. Your product contains no user serviceable components and this warranty becomes invalid if in our opinion the product has been misused, abused, incorrectly installed, tampered with, connected to an electrical supply not corresponding with the name plate specification, or subjected to power surges. The warranty does not include any labour or other associated expense that may be involved in removal or installation of the product. Normal wear and tear is expressly excluded.

If your Goldair product fails to operate satisfactorily, please return it to the retailer from whom it was purchased. To obtain a repair or replacement product under this warranty, you will need to produce satisfactory evidence of date of purchase. The completed warranty and purchase receipt must be presented with the product. The warranty should be filled out at the time of purchase. It is in your interest to make sure this is done.

If the product is to be replaced (cannot be repaired) then that replacement will be of the same or similar product or accessory excluding packaging, instruction card etc. Where a replacement product is supplied, this shall be guaranteed for the balance of the original warranty period.

Any model that is no longer available will be replaced by a model of a value and with such features as we consider appropriate in the circumstances. Goldair Ltd is not responsible for freight forwarding charges, losses or damage in transit.

If service is required after the warranty period has expired, the product should be returned to a qualified electrical technician. Service outside of the warranty period will be at your cost.

Consumers Guarantee Act (1993).

In accordance with the above act consumers are advised that: The manufacturer does not undertake that repair facilities and parts are necessarily available for this product.

If any of the provisions of the foregoing are contrary to any relevant legislation, then that provision shall be deemed to be excluded from the warranty and the rest of the provisions will continue to apply.

## IMPORTANT: PLEASE RETAIN THIS WARRANTY CARD

NAME: \_\_\_\_\_

ADDRESS: \_\_\_\_\_

PURCHASED FROM: \_\_\_\_\_

SUBURB: \_\_\_\_\_

DATE OF PURCHASE: \_\_\_\_\_

NAME OF PRODUCT: \_\_\_\_\_

MODEL No: \_\_\_\_\_

**TWO YEAR WARRANTY**